

Accesorios



Catálogo *online*

García 1880

AYUDAS

MOVILIDAD



www.garcia1880.com

813

Rubber ferrule for wooden canes.
Sizes: 10-12-14-16-18-20-22 mm.



814

Black rubber ferrule with suction. Sizes: 16 -18 mm.



815

Black rubber ferrule for crutches with metal ring in the inside.
Sizes: 19 - 21 mm.



816

Grey rubber ferrule for crutches with metal ring in the inside.
Sizes: 19 - 21 mm.



817

Articulated black rubber ferrule with metal ring in the inside.
Sizes: 19 - 21 mm.



818

Articulated grey rubber ferrule with metal ring in the inside.
Sizes: 19 - 21 mm.



822

Grey rubber ferrule for walkers with metal ring in the inside.
Sizes: 22 - 25 - 28 mm.



823

Grey rubber ferrule for shower benches with metal ring in the inside.
Sizes: 25 - 28 mm.



824

Black rubber ferrule replacement for exercise peddlers.
Size: 20 mm.

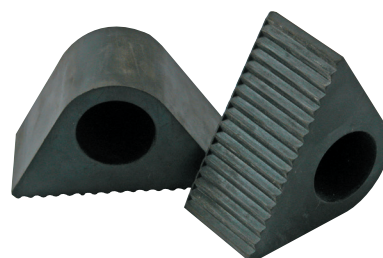

812

Metal spike ferrule.
Sizes: 18–20–22 mm.



825

Black rubber ferrule for aluminium walking sticks with metal ring in the inside. Size: 14 mm.



826

Brown rubber ferrule for aluminium walking sticks with metal ring in the inside. Size: 14 mm.



827

Fluorescent rubber ferrule with metal ring in the inside.
Size: 19 mm.



828

Black rubber ferrule for hiking sticks with metal ring in the inside. Size: 12 mm.



8281

Black wide base rubber ferrule for hiking sticks.
Size: 15 mm.



831

Flexy black rubber ferrule with 4 cm base.
Sizes: 16 – 19 mm.



832

Black rubber ferrule replacement for quad canes ref. 352 and 3521. Size: 12 mm.



834

Black rubber ferrule with hexagonal base and with metal ring in the inside. Size: 21 mm.



8342

Black rubber ferrule with 2.5 cm base.
Size: 16 mm.



835

Flexy black rubber ferrule. Size: 19 mm.



838

Swivel black rubber ferrule. Size 19 mm.



839

Black rubber ferrule for **ice and snow**. Size 19 mm.



815191

Colour rubber ferrule for crutches with metal ring in the inside. Size: 19 mm.
Available colours: Red, Purple, Blue and Green.



Wide base ferrules

Rubber ferrules suitable for all types of canes (wooden and aluminium). They provide their user with greater stability whilst walking. In addition, they prevent the cane from falling.



Wide base rubber ferrules for wet surfaces.

Base Diameter: 8 cm. Measurements: 19 and 21 mm.

These high-quality ferrules offer the user of crutches increased manoeuvrability, stability & safety on uneven and wet surfaces.

Their slip-resistant base is in contact with the ground at all times.



819

Flexi black rubber ferrule with 5.5 cm base.

Sizes: 17 – 19 – 21 mm.

821

Flexi tripod rubber ferrule with 12 cm base and with metal ring in the inside. Size: 19 mm.

8291

Tripod rubber ferrule with 7.5 cm base and with metal ring in the inside. Sizes: 16 - 19 mm.



829

Tripod rubber ferrule with 10 cm base and with metal ring in the inside. Sizes: 16-19 mm.



833

Tripod rubber ferrule replacement for 2157 and 21571 crutches. Size: 21 mm.



844

Wide base rubber ferrule with 12 cm base.

Sizes: 16 - 19 mm.



846

Wide base rubber **ferrule with suspension**. Only size, adaptable to sizes: 16 and 19 mm.

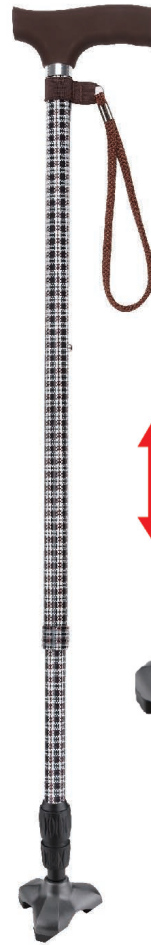

842

Quad rubber ferrule for aluminium walking sticks with 15 cm base.

Sizes: 16 - 19 mm.



840

Quad rubber ferrule for aluminium walking sticks with 8 cm base.

Sizes: 16 - 19 mm.

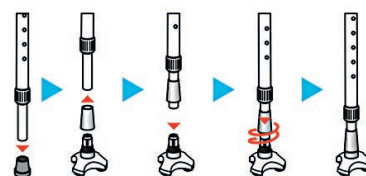

Walking sticks accessories

810

Black, brown, red, grey or beige cane wrist strap.



8102 8103 8104 8101 Marrón 810 Negro

8301



830



Cane Holder: Enables you to easily balance your walking stick on the edge of a table.

836

Cane holder for walkers, rollators and wheelchairs.



811

Hand pads. Stretchy hand pads which can be attached to the handles of most mobility aids.



837

Cane holder for walkers, rollators and wheelchairs.



2576

Attachable wheelchair and rollator 3 in 1 holder, perfect to hold your drink, cane or torch.



Displays

794

Acrylic display for 10 folding walking sticks.



795

Cardboard display for 12 walking sticks.



803

Wooden display for 15 walking sticks. Three levels. Size: 46 x 21 x 71cm.

804

Wooden display for 18 walking sticks. Size: 33 x 50 cm.

805

Wooden display for 12 walking sticks. Size: 27 x 50 cm.

803



804



805



789

Steel swivel display for 24 walking Sticks or crutches. Two levels. 12 pieces per level.



799

Steel swivel display for 12 folding walking Sticks.



7951

Cardboard display for accessories.



797

800

801

Steel display for walking sticks and accessories. Available in black and white colours.

800

Size: 183 x 40 cm.

798

Hook to use in displays.

801

Size: 183 x 60 cm.

797

Size: 183 x 25 cm.





www.garcia1880.com

GENERAL SALES TERMS & CONDITIONS

ORDERS

There is no minimum order quantity. You can order just what you need anytime you need it.

You can place your order at any time by sending us an email at walkingsticks@garcia1880.com or via your client account on our website www.garcia1880.com

PAYMENTS

García 1880 will issue the payment of your orders based on the agreed conditions.

The first order from new customers will be confirmed after receiving payment.

WARRANTY

García 1880 products are guaranteed against any manufacturing defects for a period of two years (six months if batteries) from the date of the purchase invoice. The warranty includes repair, replacement and / or product exchange, depending on the assessment of the problem.

Please note that damages caused by its use, lack of maintenance, natural wear or improper use are not covered under warranty.

Repairs or manipulations not carried out by García 1880 invalidate the warranty.

RETURNS POLICY

All our clients have a 6-month period from the date of the invoice to return the item at their own expense. Please note that the item must be in its original packaging and that a processing and/or demerit cost may be applicable.

Note that to validate the return it is necessary to meet the following requirements:

- The product must not have been tampered with and must maintain its original appearance.
- It must be returned packed in its original packaging and in such a way that it does not deteriorate during transport.
- It should contain all accessories, user manual and any other original documentation.
- The return will not be possible if the item has been discontinued.

In order to proceed with a return, please contact our Customer Service department. García 1880 will review the received information and will contact you with instructions on how to proceed.

INCIDENT IN THE RECEPTION, FAULTS OR BREAKS

An incident is considered to be any error made in the shipment of the product, due to causes beyond customer's control.

You must check the status of the merchandise upon receipt. In the event of an incident (lack of an item, breakage or damage), it must be stated on the delivery note of the transport agency and communicated in writing to García 1880 within the next 48 hours.

To report an incident, you must contact our customer service department and send the following information:

- Customer's name and full address
- Photos of the label of the product
- Photos of the product
(and, if applicable, of the damaged part)
- Explanation of the problem

Please note that no incident will be processed without all the previously mentioned information.

Once the information has been received and reviewed by our team, García 1880 will assess the solution and will contact you. If it is necessary to evaluate the product in our warehouse, our transport agency will pick up the product at the place of delivery.

Only if the product sent is the wrong one, has a manufacturing defect or was damaged due to transport, the costs associated with transport will be assumed by García 1880.

CUSTOMER SERVICE DEPARTMENT

Opening times: M-F 09:00-18:00h

Phone number: (+34) 964 710 322

Whatsapp: (+34) 609 162 380

e-mail: walkingsticks@garcia1880.com